

740BW

IP65 7*40W 4in1 Bee Eye Moving Head

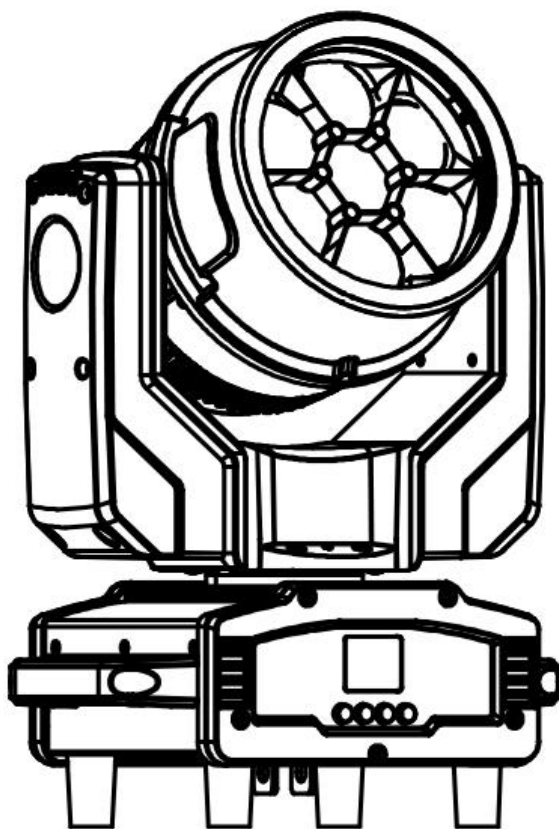

User manual

Please read the instructions carefully before use

TABLE OF CONTENTS

| | |
|-----------------------------------|-------|
| 1. Safety Instructions | 3-4 |
| 2. Technical Specifications | 5 |
| 3.Lux date..... | 6 |
| 4. How To Control The Unit..... | 6-9 |
| 5. DMX Channels | 10-24 |
| 6. shape | 25 |
| 7. Trouble shooting | 26 |
| 8. Fixture Cleaning | 27 |

statement

The product has well capability and intact packing when leave factory. All of the user should comply with warning item and manual, any misuse cause of the damages are not included in our guarantee, and also can't be responsible for any malfunction & problem owing to ignore the manual.

1. Safety Instructions

Please keep this User Guide for future consultation. If you sell the unit to another user, be sure that they also receive this instruction booklet.

- Unpack and check carefully there is no transportation damage before using the unit.
- Before operating, ensure that the voltage and frequency of power supply match the power requirements of the unit.
- It's important to ground the yellow/green conductor to earth in order to avoid electric shock.
- The unit is for outdoor use.
- The unit must be installed in a location with adequate ventilation, at least 50 cm from adjacent surfaces. Be sure that no ventilation slots are blocked.
- Disconnect main power before replacement or servicing.
- Make sure there are no flammable materials close to the unit while operating as it is fire hazard.
- Use safety cable when fixes this unit. Do not handle the unit by taking its head only, but always by taking its base.
- Maximum ambient temperature is $T_a: 40^{\circ}\text{C}$. Do not operate it where the temperature is higher than this Unit surface temperature may reach up to 85°C . Do not touch the housing bare-hand during its operation. Turn off the power and allow about 15 minutes for the unit to cool down before replacing or serving.
- the event of serious operating problem, stop using the unit immediately. Never try to repair the unit by yourself. Repairs carried out by unskilled people can lead to damage or malfunction. Please contact the nearest authorized technical assistance center. Always use the same type spare parts.
- Do not touch any wire during operation as high voltage might be causing electric shock.

Warning:

- To prevent or reduce the risk of electrical shock or fire, do not expose the unit to rain or moisture.
- Do not open the unit within five minutes after switching off.
- The housing, the lenses, or the ultraviolet filter must be replaced if they are visibly damaged.

Caution:

There are no user serviceable parts inside the unit. Do not open the housing or attempt any repairs yourself. In the unlikely event your unit may require service, please contact your nearest dealer.

Installation:

The unit should be mounted via its screw holes on the bracket. Always ensure that the unit is firmly fixed to avoid vibration and slipping while operating. And make sure that the structure to which you are attaching the unit is secure and is able to support a weight of 10 times of the unit's weight. Also always use a safety cable that can hold 12 times of the weight of the unit when installing the fixture.

The equipment must be fixed by professionals. And it must be fixed at a place where is out of the touch of people.

2. Technical Specifications

Light Sources: 7x40W 4IN1 RGBW LED

Beam Angle: 3.5°-45°

Glass Light Guide + PMMA High Quality Optical Lens

Power Consumption: 240W

Power Voltage: AC 100-240V, 50/60Hz

Dimension: 625*400*590mm

Net Weight: 10.9 kg

Carton package 2in1 size: 62.5*40*59cm Gross weight: 29.5 kg

Flight Case package 4in1 size: 68.5*70.5*65cm Gross weight: 84.5 kg

Control

DMX Channel: 21/24/32/60 Channels

Control Modes: DMX512/Master-Slave/Auto Run/Music/RDM

Pan/Tilt

Pan/Tilt: 540°/ 270°

Pan/Tilt Resolution: 8/16 bit Adopt Photoelectric Reset System

Construction

Display: TFT1.8 Inch Color Display

Data In/Out socket: 3-pin XLR sockets or 5-pin XLR sockets(Optional)

Power Socket: Power con in/out

Protection Rating: IP65

Features

Motorized liner zoom system, zoom range: 3.5°~45°

Pixels control

Outstanding color macro effect

Dimmer: 0~100% smooth dimming

Variable strobe effects

Fast, quiet operation and flicker free

3. How To Control The Unit

The DMX512 is widely used in intelligent lighting control, with a DMX 512 controller. connect several lights together, dmx in and dmx out, 3 pin XLR connectors: Pin 1: GND, Pin 2: Negative signal (-), Pin 3: Positive signal (+)

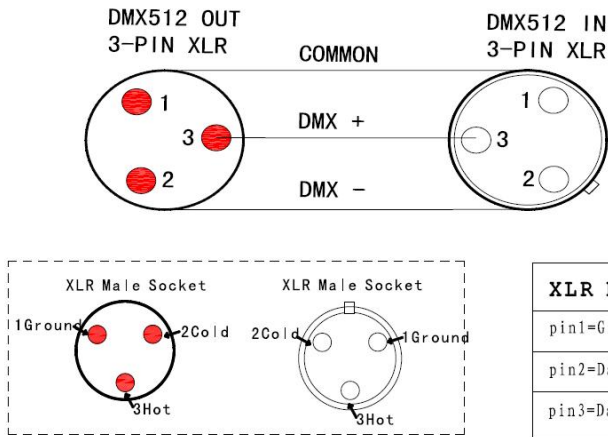
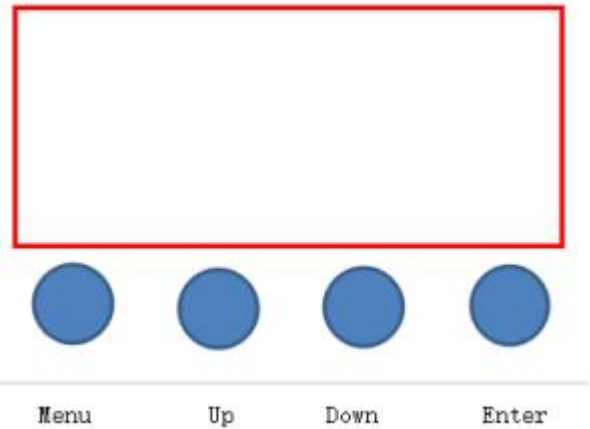

Figure2

Display:



| | |
|-------|--|
| MENU | To select the programming functions |
| DOWN | To go backward in the selected functions |
| UP | To go forward in the selected functions |
| ENTER | To confirm the selected functions |

Set DMX Address Code

- 1 Press **"Menu"** to "Set DMX Address", and press **"ENTER"** keys to enter into
- 2 Show "Set DMX Address DMX Address:**001**", Press the **"UP and DOWN"** keys to amended
- 3 Press **"ENTER"** keys to save and Exit, Press the **"MENU"** Keys does not save and Exit

| | | | |
|------|--------------|------------------------|---|
| Menu | 1.Pan Degree | 1.540 2.360 | Pan running angle selection |
| | 2.Sound | 001--100 | Sound control sensitivity adjustment |
| | 3.Language | 1.English 2.Chinese | Choose language |
| | 4.No Signal | 1.BlackOut 2.Hold | |
| | 5.Fan Set | 1.Auto 2.Low 3.High | |
| | 6.Reset | 1.Yes | Reset |
| | | 2.No | |
| | 7.Default | 1.Yes | Factory setting |
| | | 2.No | |
| | 8.Adjust | Pass word | **** |
| | | 1.Pan | Change the value of Pan/Tilt/Focus/Rota to adjust the |
| | | 2.Tilt | |

| | | | |
|---------|--------------------|---------------|--|
| | | 3.Focus | angle; change the value of R/G/B/W to adjust the white balance |
| | | 4.Rotate | |
| | | 5.Red | |
| | | 6.Green | |
| | | 7.Blue | |
| Address | Address 001~512 | | Address setting 001-512 |
| Rever | 1.Pan Invert | 1.NO,2.YES | Pan forward and reverse setting |
| | 2.Tilt Invert | 1.NO,2.YES | Tilt forward and reverse setting |
| | 3.Display Invert | 1.NO,2.YES | Display reverse setting |
| Inform | 1.CH Value | | Show the version number |
| | 2.Temp /°C | | Show the temperature of led board |
| | 3.Soft V1.0 | | Program version number |
| Mode | 1.DMX512 | | Select Mode |
| | 2.Auto | | |
| | 3.Sound | | |
| | | Master/Alone | Master/Alone |
| | 4.Manual | 1.Pan:0-255 | Manual control |
| | | 2.Tilt:0-255 | |
| | | 3.Focus:0-255 | |

| | | | |
|---------|------|----------------|---------------------|
| | | 4.Red:0-255 | |
| | | 5.Green:0-255 | |
| | | 6.Blue:0-255 | |
| | | 7.White:0-255 | |
| | | 8.Strobe:0-255 | |
| Channel | 21CH | 21CH | Choose Channel Mode |
| | 24CH | 24CH | |
| | 32CH | 32CH | |
| | 60CH | 60CH | |

4.DMX Channels

DMX channel's functions and values (21 DMX channels):

21 Channel Mode:

| Channel | Function | Description | Value |
|---------|------------------|------------------|----------|
| Ch 1 | Red | Red dimming | 0----255 |
| Ch 2 | Red adjustment | Red adjustment | 0----255 |
| Ch 3 | Green | Green dimming | 0----255 |
| Ch 4 | Green adjustment | Green adjustment | 0----255 |
| Ch 5 | Blue | Blue dimming | 0----255 |
| Ch 6 | Blue adjustment | Blue adjustment | 0----255 |
| Ch 7 | White | White dimming | 0----255 |
| Ch 8 | White adjustment | White adjustment | 0----255 |
| | Linear Color | No function | 0-4 |

| | | | |
|-------|-----------------|---|------------|
| Ch9 | Temperature | Color temperature from warm to cool | 5-255 |
| Ch 10 | Macro color | No function | 0----9 |
| | | Macro color 1 | 10----19 |
| | | Macro color 2 | 20----29 |
| | |(10 numbers 1 macro color) | |
| | | Macro color 19 | 190----199 |
| | | Macro color 20 | 200----255 |
| Ch 11 | Dimmer | dark to bright linear dimming | 0----255 |
| Ch 12 | Dimmer adjust | Dimmer adjustment control | 0----255 |
| Ch 13 | Strobe | Turn on the light/No function | 0----3 |
| | | Synchro strobe speed slow to fast (1HZ-25HZ) | 4----203 |
| | | Random strobe | 204----255 |
| Ch 14 | Pan | Pan control | 0----255 |
| Ch 15 | Pan adjustment | Pan adjustment control | 0----255 |
| Ch 16 | Tilt | Tilt control | 0----255 |
| Ch 17 | Tilt adjustment | Tilt adjustment control | 0----255 |
| Ch 18 | zoom | zoom | 0----255 |
| Ch 19 | Lens rotation | 0~60° | 0-155 |
| | | Counter Clockwise infinite rotation from fast to slow | 156-205 |
| | | Clockwise infinite rotation from slow to fast | 206-255 |
| | | Mode -1 | 0 --- 49 |
| | | Mode -2 | 50 --- 99 |

| | | | |
|-------|--------------|-----------------|-----------|
| Ch 20 | Dimming Mode | Mode -3 | 100---149 |
| | | Mode -4 | 150---255 |
| Ch 21 | Reset | NO | 0-250 |
| | | Reset within 5s | 251---255 |

DMX channel's functions and values (24 DMX channels):

24 channel mode:

| Channel | Function | Description | Value |
|---------|----------------------|---|------------|
| Ch 1 | pan adjustment | pan adjustment | 0----255 |
| Ch 2 | Pan fine adjustment | Pan fine adjustment | 0----255 |
| Ch 3 | Tilt adjustment | Tilt adjustment | 0----255 |
| Ch 4 | Tilt fine adjustment | Pan fine adjustment | 0----255 |
| Ch 5 | Speed of Pan/Tilt | from fast to slow | 0----255 |
| Ch 6 | zoom | from small to large | 0----255 |
| Ch 7 | Lens rotation | 0-60° | 0----155 |
| | | Counter clockwise infinite rotation from fast to slow | 156----205 |

| | | | |
|-------|-----------------------------|---|------------|
| | | Counter clockwise rotation from slow to fast | 206----255 |
| Ch 8 | Dimmer | from dark to bright | 0----255 |
| Ch 9 | Strobe | Turn on the light | 0----3 |
| | | Synchro strobe speed slow to fast (1HZ-25HZ) | 4----203 |
| | | Random strobe | 204----255 |
| Ch 10 | R | from dark to bright | 0----255 |
| Ch 11 | G | from dark to bright | 0----255 |
| Ch 12 | B | from dark to bright | 0----255 |
| Ch 13 | W | from dark to bright | 0----255 |
| Ch14 | Linear Color Temperature | No function | 0-4 |
| | | Color temperature from warm to cold | 5-255 |
| Ch 15 | Macro color | No function | 0----9 |
| | | Macro color 1 | 10----19 |
| | | Macro color 2 | 20----29 |
| | |(10 numbers 1 macro color) | |
| | | Macro color 19 | 190----199 |
| | | Macro color 20 | 200----255 |
| Ch 16 | Pattern rotation | No function | 0----9 |

| | | | |
|-------|-------------------------------------|-----------------------------------|--|
| | | Monochrome dynamic pattern 1 | 10----14 |
| | | Monochrome dynamic pattern 2 | 15----19 |
| | | |(5numbers s 1 pattern)..... |
| | | Monochrome dynamic pattern 20 | 105----109 |
| | | Mixed color dynamic pattern 1 | 110----114 |
| | | Mixed color dynamic pattern 2 | 115----119 |
| | | |(5 numbers 1 pattern) |
| | | Mixed color dynamic pattern 12 | 165----169 |
| | | Mixed color dynamic pattern 13 | 170----255 |
| Ch 17 | Pattern movement | Pattern movement(with 16CH) | 0----255 |
| Ch 18 | Pattern effect speed (with 16CH) | No function | 0----9 |
| | | Forward, from fast to slow | 10----132 |
| | | Reverse, from slow to fast | 133----255 |

| | | | |
|-------|--------------|------------------------------------|------------|
| Ch 19 | Background R | Linear dimming from dark to bright | 0----255 |
| Ch 20 | Background G | Linear dimming from dark to bright | 0----255 |
| Ch 21 | Background B | Linear dimming from dark to bright | 0----255 |
| Ch 22 | Background W | Linear dimming from dark to bright | 0----255 |
| Ch 23 | Dimming Mode | Mode -1 | 0----49 |
| | | Mode -2 | 50----99 |
| | | Mode -3 | 100----149 |
| | | Mode -4 | 150----255 |
| Ch 24 | Reset | No function | 0----250 |
| | | Reset 5s | 251----255 |

DMX channel's functions and values (32 DMX channels):

32 channel mode:

| Channel | Function | Description | Value |
|---------|----------------------|---------------------|----------|
| Ch 1 | pan adjustment | pan adjustment | 0----255 |
| Ch 2 | Pan fine adjustment | Pan fine adjustment | 0----255 |
| Ch 3 | Tilt adjustment | Tilt adjustment | 0----255 |
| Ch 4 | Tilt fine adjustment | Pan fine adjustment | 0----255 |

| | | | |
|-------|-------------------|---|------------|
| Ch 5 | Speed of Pan/Tilt | from fast to slow | 0----255 |
| Ch 6 | Zoom | Zoom | 0----255 |
| Ch 7 | Lens rotation | 0-60° | 0----155 |
| | | Clockwise infinite rotation from fast to slow | 156----205 |
| | | Counter clockwise rotation from slow to fast | 206----255 |
| Ch 8 | Dimmer | from dark to bright | 0----255 |
| Ch 9 | Dimmer adjust | Dimmer adjustment control | 0----255 |
| Ch 10 | Strobe | Turn on the light | 0----3 |
| | | Synchro strobe speed slow to fast (1HZ-25HZ) | 4----203 |
| | | Random strobe | 204----255 |
| Ch 11 | R | Red dimming | 0----255 |
| Ch 12 | Red adjust | Red adjust | 0----255 |
| Ch 13 | G | Green dimming | 0----255 |
| Ch 14 | Green adjust | Green adjust | 0----255 |
| Ch 15 | B | Blue dimming | 0----255 |
| Ch 16 | Blue adjust | Blue adjust | 0----255 |
| Ch 17 | W | White dimming | 0----255 |
| Ch 18 | White adjust | White adjust | 0----255 |
| Ch 19 | Dimming Mode | Mode -1 | 0 --- 49 |
| | | Mode -2 | 50 --- 99 |
| | | Mode -3 | 100---149 |

| | | | |
|-------|-----------------------|-------------------------------------|------------|
| | | Mode -4 | 150---255 |
| CH20 | Linear Temperature | No function | 0---4 |
| | | Color temperature from warm to cold | 5---255 |
| Ch 21 | Macro color | No function | 0----9 |
| | | Macro color 1 | 10----19 |
| | | Macro color 2 | 20----29 |
| | |(10 numbers 1 macro color) | |
| | | Macro color 19 | 190---199 |
| | | Macro color 20 | 200----255 |
| Ch 22 | Pattern rotation | No function | 0----9 |
| | | Monochrome dynamic pattern 1 | 10----14 |
| | | Monochrome dynamic pattern 2 | 15----19 |
| | |(5 numbers 1 pattern) | |
| | | Monochrome dynamic pattern 20 | 105----109 |
| | | Mixed color dynamic pattern 1 | 110----114 |
| | | Mixed color dynamic pattern 2 | 115----119 |

| | | | |
|-------|---------------------------------|--------------------------------|------------|
| | |(5 numbers 1 pattern) | |
| | | Mixed color dynamic pattern 12 | 165----169 |
| | | Mixed color dynamic pattern 13 | 170----255 |
| Ch 23 | Pattern movement | Pattern movement(with 22CH) | 0----255 |
| Ch 24 | Pattern effect speed(with 22CH) | No function | 0----9 |
| | | Forward, from fast to slow | 10----132 |
| | | Reverse, from slow to fast | 133----255 |
| Ch 25 | Pattern effect fade | Pattern effect fade | 0----255 |
| Ch 26 | Background dimming | Background 0-100% dimming | 0----255 |
| Ch 27 | Background strobe | Background strobe | 0----255 |
| Ch 28 | Background R | dark to bright | 0----255 |
| Ch 29 | Background G | dark to bright | 0----255 |
| Ch 30 | Background B | dark to bright | 0----255 |
| Ch 31 | Background W | dark to bright | 0----255 |

| | | | |
|-------|-------|-------------|------------|
| Ch 32 | Reset | no function | 0----250 |
| | | Reset 5s | 251----255 |

DMX channel's functions and values (60 DMX channels):

60 channel mode:

| Channel | Function | Description | Value |
|---------|----------------------|---|------------|
| Ch 1 | pan adjustment | pan adjustment | 0----255 |
| Ch 2 | Pan fine adjustment | Pan fine adjustment | 0----255 |
| Ch 3 | Tilt adjustment | Tilt adjustment | 0----255 |
| Ch 4 | Tilt fine adjustment | Pan fine adjustment | 0----255 |
| Ch 5 | Speed of Pan/Tilt | from fast to slow | 0----255 |
| Ch 6 | Zoom | Zoom | 0----255 |
| Ch 7 | Lens rotation | 0-60° | 0----155 |
| | | Clockwise infinite rotation from fast to slow | 156----205 |
| | | Counterclockwise rotation from slow to fast | 206----255 |
| Ch 8 | Dimmer | Linear dimming from dark to bright | 0----255 |
| Ch 9 | Dimmer adjust | Dimmer adjustment control | 0----255 |
| Ch 10 | Strobe | Turn on the light | 0----3 |
| | | Synchro strobe speed slow to fast (1HZ-25HZ) | 4----203 |
| | | Random strobe | 204----255 |
| Ch 11 | R | Red dimming | 0----255 |

| | | | |
|-------|--------------------------|-------------------------------------|------------|
| Ch 12 | Red adjust | Red adjust | 0----255 |
| Ch 13 | G | Green dimming | 0----255 |
| Ch 14 | Green adjust | Green adjust | 0----255 |
| Ch 15 | B | Blue dimming | 0----255 |
| Ch 16 | Blue adjust | Blue adjust | 0----255 |
| Ch 17 | W | White dimming | 0----255 |
| Ch 18 | White adjust | White adjust | 0----255 |
| Ch 19 | Dimming Mode | Mode -1 | 0 --- 49 |
| | | Mode -2 | 50 --- 99 |
| | | Mode -3 | 100---149 |
| | | Mode -4 | 150---255 |
| CH20 | Linear color temperature | No function | 0----4 |
| | | Color temperature from warm to cool | 5----255 |
| Ch 21 | Macro color | No function | 0----9 |
| | | Macro color 1 | 10----19 |
| | | Macro color 2 | 20----29 |
| | |(10 numbers 1 macro color) | |
| | | Macro color 19 | 190----199 |
| | | Macro color 20 | 200----255 |

| | | | |
|-------|---------------------------------|--------------------------------|------------|
| Ch 22 | Pattern rotation | No function | 0----9 |
| | | Monochrome dynamic pattern 1 | 10----14 |
| | | Monochrome dynamic pattern 2 | 15----19 |
| | |(5 numbers 1 pattern) | |
| | | Monochrome dynamic pattern 20 | 105----109 |
| | | Mixed color dynamic pattern 1 | 110----119 |
| | | Mixed color dynamic pattern 2 | 150----159 |
| | |(5 numbers 1 pattern) | |
| | | Mixed color dynamic pattern 12 | 165----169 |
| | | Mixed color dynamic pattern 13 | 170----255 |
| Ch 23 | Pattern movement | Pattern movement(with 22CH) | 0----255 |
| Ch 24 | Pattern effect speed(with 22CH) | No function | 0----9 |
| | | Forward, from fast to slow | 10----132 |
| | | Reverse, from slow to fast | 133----255 |

| | | | |
|-------|---------------------|---------------------------|------------|
| Ch 25 | Pattern effect fade | Pattern effect fade | 0----255 |
| Ch 26 | Background dimming | Background 0-100% dimming | 0----255 |
| Ch 27 | Background strobe | Background strobe | 0----255 |
| Ch 28 | Background R | dark to bright | 0----255 |
| Ch 29 | Background G | dark to bright | 0----255 |
| Ch 30 | Background B | dark to bright | 0----255 |
| Ch 31 | Background W | dark to bright | 0----255 |
| Ch 32 | Reset | no function | 0----250 |
| | | Reset 5s | 251----255 |
| Ch 33 | R1 LED | R1 LED1 dimming | 0----255 |
| Ch 34 | G1 LED | G1 LED1 dimming | 0----255 |
| Ch 35 | B1 LED | B1 LED1 dimming | 0----255 |
| Ch 36 | W1 LED | W1LED1 dimming | 0----255 |
| | | | |
| Ch 57 | R7 LED | R7 LED dimming | 0----255 |
| Ch 58 | G7 LED | G7 LED dimming | 0----255 |
| Ch 59 | B7 LED | B7 LED dimming | 0----255 |
| Ch 60 | W7 LED | W7 LED dimming | 0----255 |

5.Shape

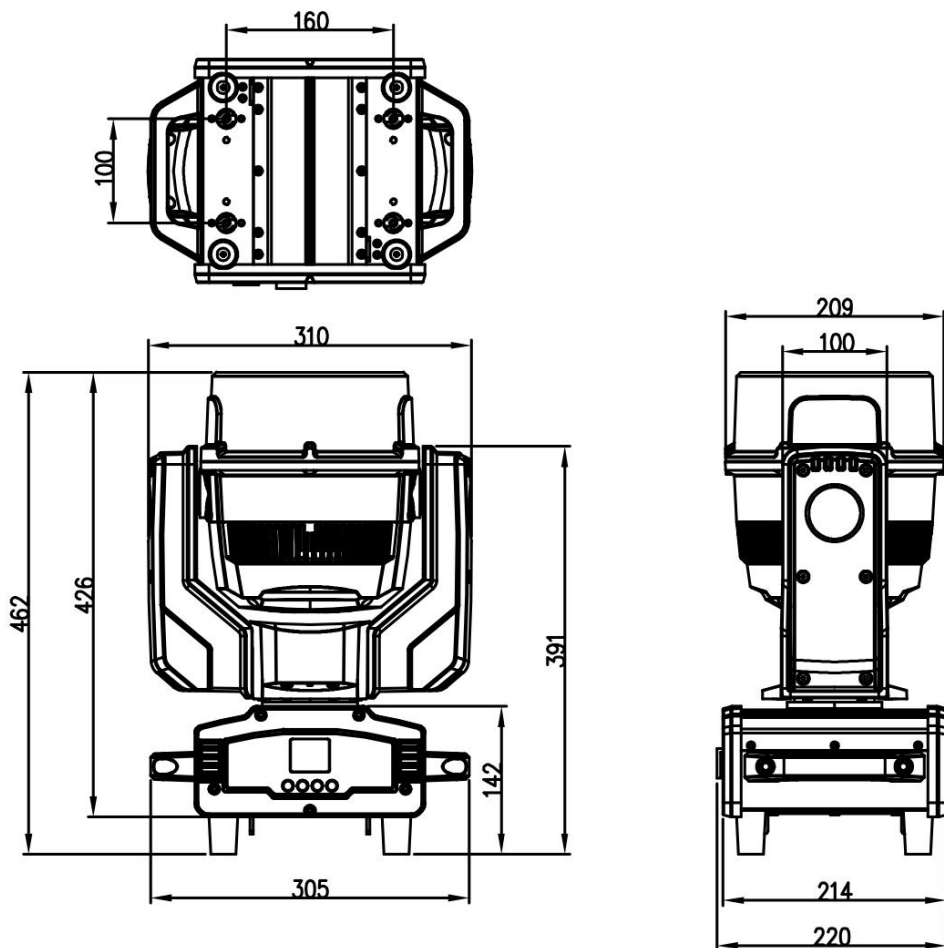

6. Trouble shooting

Following are a few common problems that may occur during operation. Here are some suggestions for easy troubleshooting:

A. The unit does not work, no light and the fan does not work

1. Check the connection of power and main fuse.
2. Measure the mains voltage on the main connector.
3. Check the power on LED.

B. Not responding to DMX controller

1. DMX LED should be on. If not, check DMX connectors, cables to see if link properly.
2. If the DMX LED is on and no response to the channel, check the address settings and DMX polarity.
3. If you have intermittent DMX signal problems, check the pins on connectors or on PCB of the unit or the previous one.
4. Try to use another DMX controller.
5. Check if the DMX cables run near or run alongside to high voltage cables that may cause damage or interference to DMX interface circuit.

C. One of the channels is not working well

1. The stepper motor might be damaged or the cable connected to the PCB is broken.
2. The motor's drive IC on the PCB might be out of condition.

7. Fixture Cleaning

The cleaning of internal and external optical lenses and/or mirrors must be carried out periodically to optimize light output. Cleaning frequency depends on the environment in which the fixture operates: damp, smoky or particularly dirty surrounding can cause greater accumulation of dirt on the unit's optics.

- **Clean with soft cloth using normal glass cleaning fluid.**
- **Always dry the parts carefully.**
- **Clean the external optics at least every 20 days. Clean the internal optics at least every 30/60 days.**